

PRESENTING

LUXURY
SWITCHES



RHOMBUS
EUROPE

SMART HOTEL CONTROL
ENERGY MANAGEMENT SYSTEM

WHAT WE DO?

Corridor panel

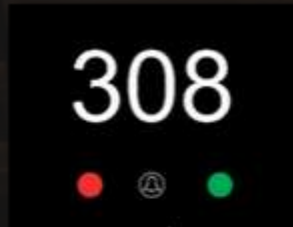

Card holder



Thermostat



Wall panel



Wall panel



- Guest Room Control Systems
- Energy Management Systems
- Lighting Controls
- Integrated Room Solutions

TYPICAL GUESTROOM

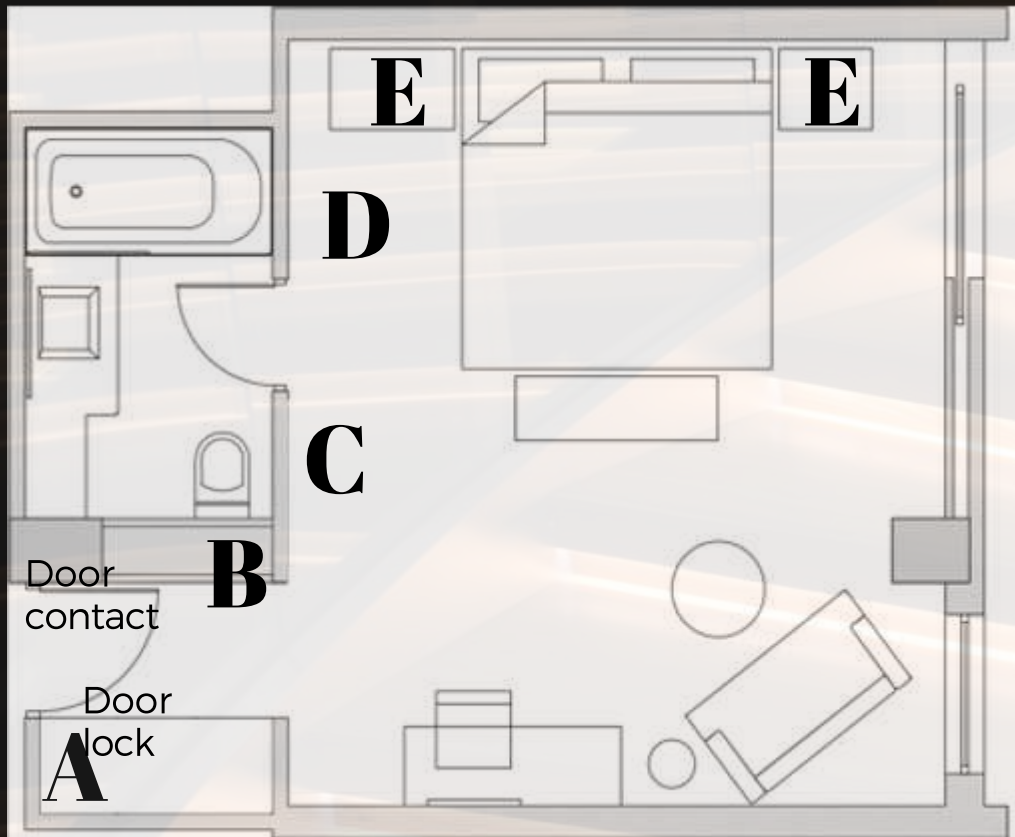

Card reader



Card holder



A B

Thermostat



Bathroom Panel



C D

Bedside Panel



E



*Usability and Guest Experience
as our core design principles*



GUESTROOM CONTROL PANELS



- Mix of icons and text
- Backlight icons for easy use at night
- Multi-color status LED
- Multi use panels, lighting, Air Con, Guest Services

DESIGN CAPABILITIES



User interface

- Focus on User-friendliness
- Developed for hospitality environment
- Icons allow quick and easy familiarisation
- Text, fonts and icons are customisable



Look and feel

- Devices can be customised to match the interior design
- Ability to incorporate logo or pattern prints
- Panel devices with elegant look and pleasing light

DESIGN CAPABILITIES

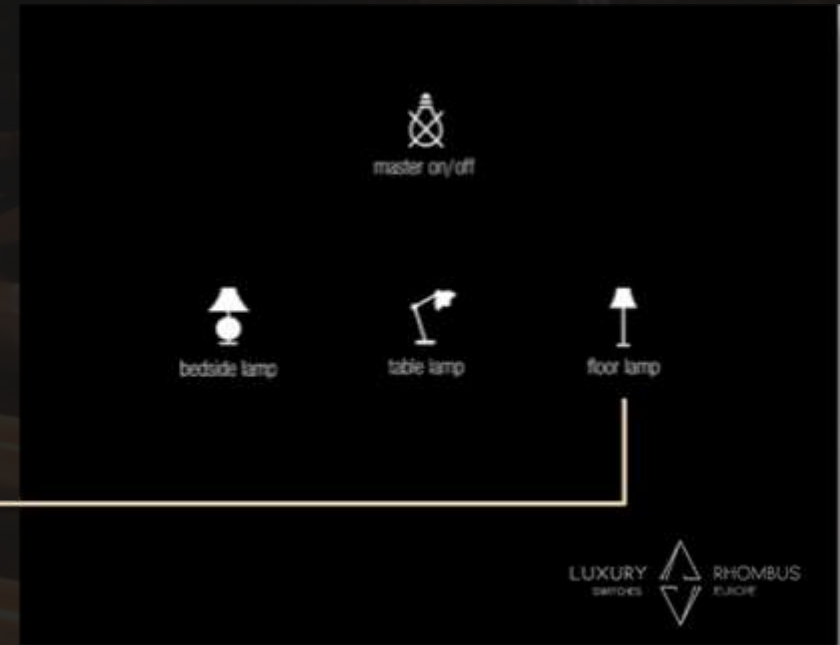

User-friendly and international

- Icons that match the real-world FF&E help the user to understand immediately what he is controlling
- Multilingual text labels make sure the system is being understood on international level

COPYRIGHT PROTECTED ICONS LIBRARY



Constantly growing & Option to create brand specific icon sets

CUSTOM SOLUTIONS



- Network infrastructure
- Functionality
- Communication
- Devices

FUNCTIONAL CONTROLLER

The BACnet Programmable Functional Controller is designed for wide range of building automation tasks. Its numerous inputs and outputs enable it to be used in many applications in building control while its BACnet connectivity enables seamless integration in Building Management System

Key features

- 8 independent SPST NO relays
- 2×3 group SPST NO relays
- 2 Triac outputs
- 12 potential-free inputs
- 3 analog outputs
- Programming is done using PC application
- Resource sharing between controllers through BACnet network. Sharing of the data is performed without intervention of the supervisory system
- Work plans stored in flash memory
- RTC (real-time clock) with auxiliary battery power

FUNCTIONAL CONTROLLER

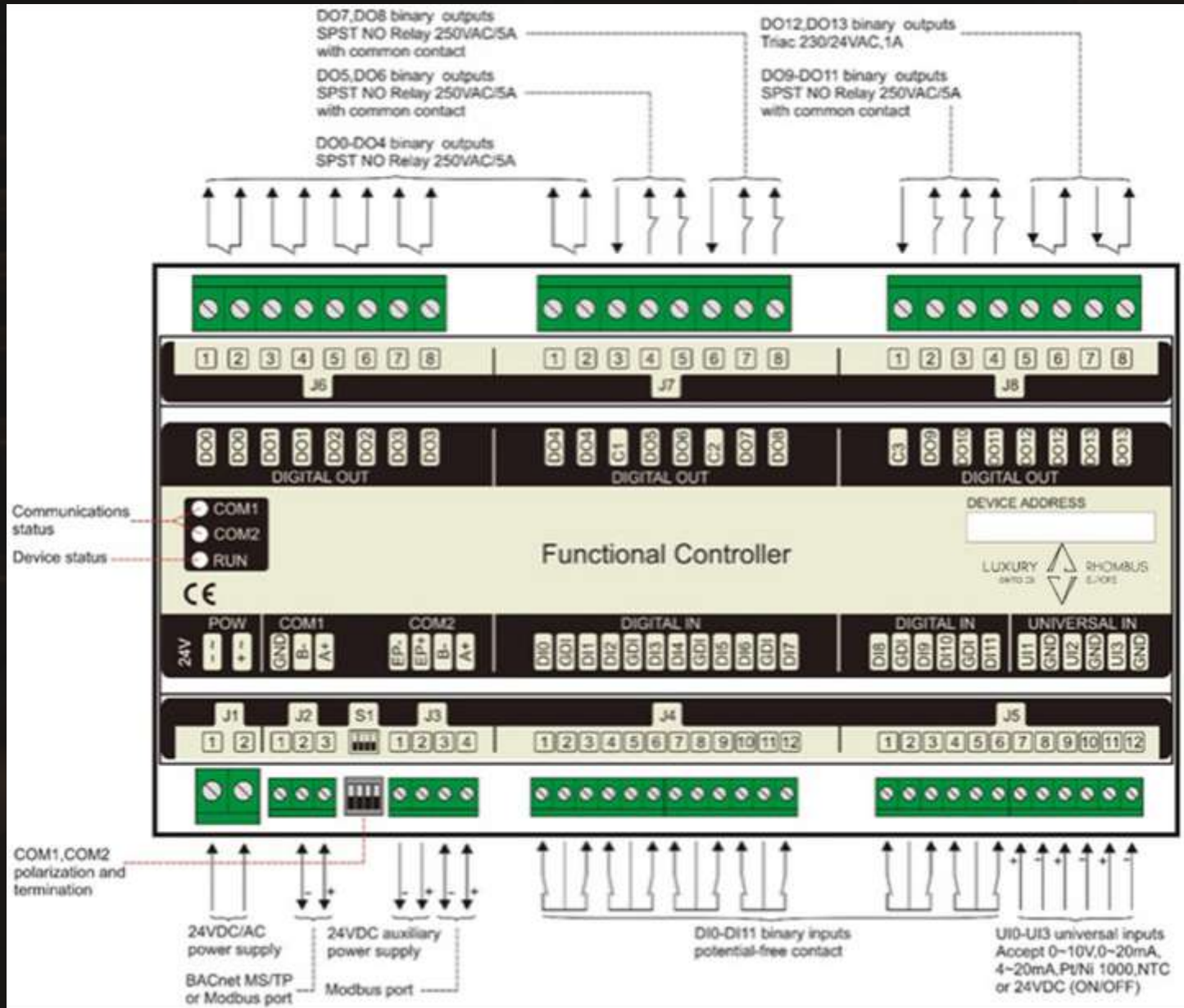

RHOMBUS-EUROPE SYSTEM

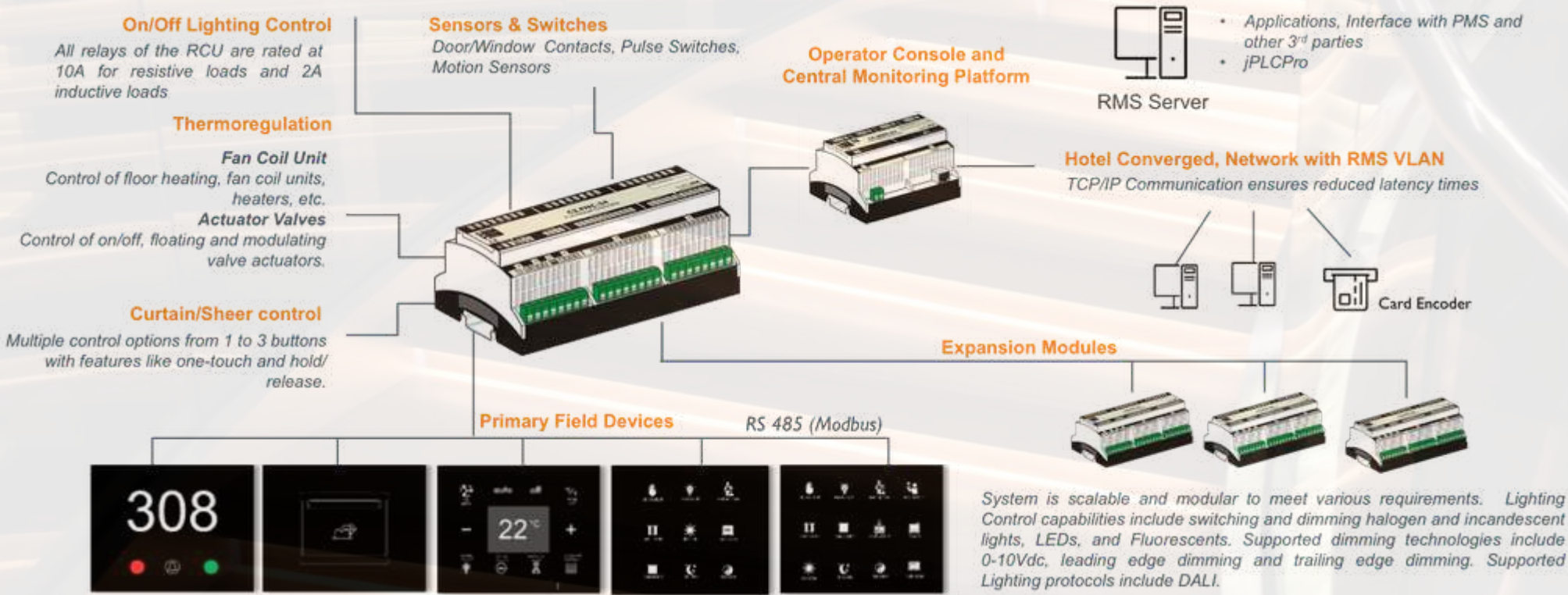

NETWORK INFRASTRUCTURE

RMS Server Room & Operator Control Centre

Client for Front desk, Housekeeping,
Engineering, Security, Management

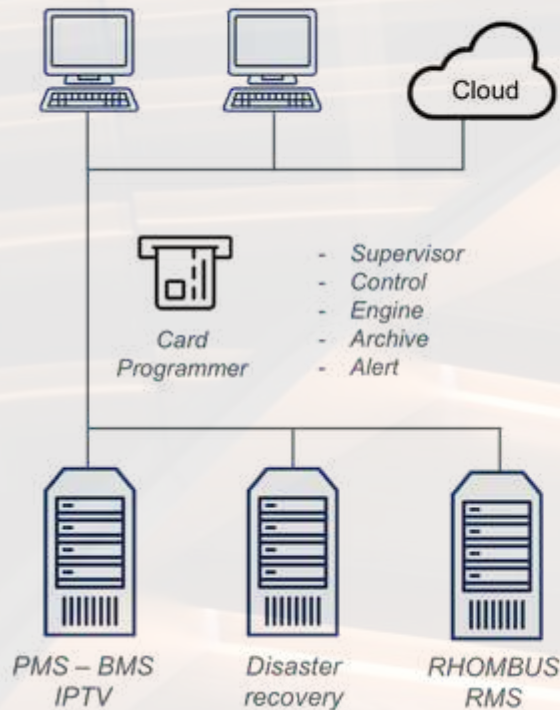

Hotel Rooms Infrastructure and Topology

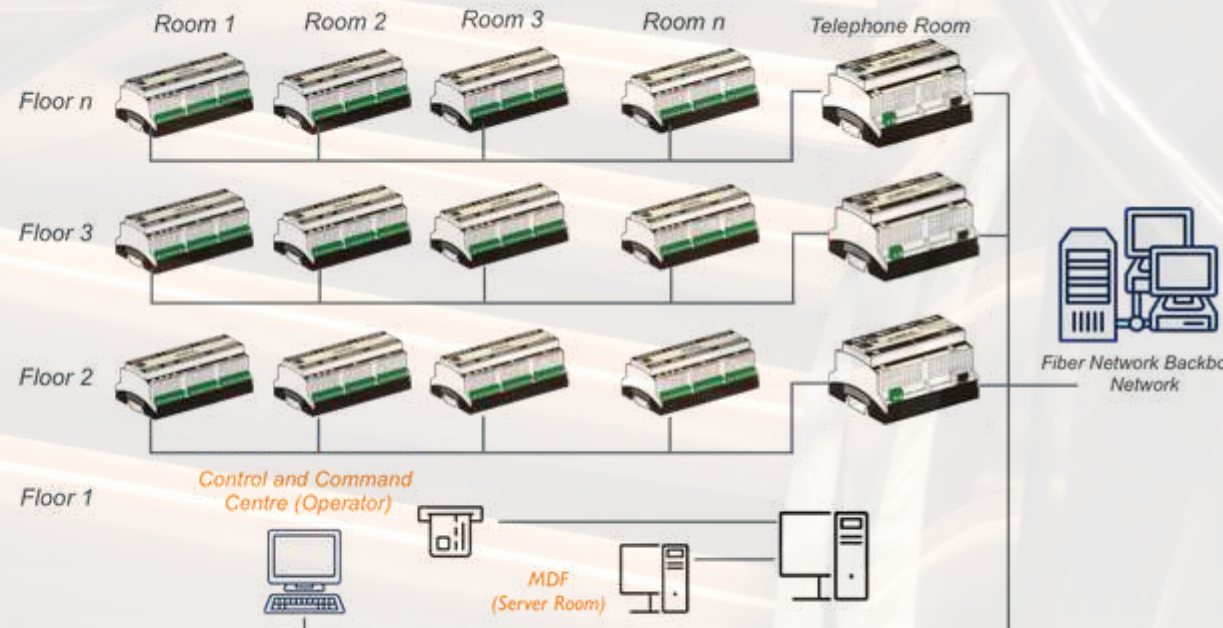

- Saving on the Power Infrastructure
- Separate VLAN for RMS

CORRIDOR STATUS PANEL

Status Panel is programmable card reader device designed for hotels. Its intended usage is to be placed in corridor beside room door. The device can provide additional functionality thanks to the one pushbutton and 4 LED indicators. The device can communicate with Mifare 1K RFID cards.

- Supports Mifare 1K RFID card
- Additional functionality provided by pushbutton and LED indicators
- Configuration, programming and debugging is done using PC based tool through USB port
- Resource sharing between controllers through BACnet network.
- Sharing of the data is performed without intervention of the supervisory system
- Jumper selectable standard polarizing and termination resistors on RS485 terminal



CARD HOLDER

Card Holder is a programmable device designed for hotels. Its intended usage is to be placed in the room entrance near the door.

The gap for card has backlight. The device can communicate with Mifare 1K RFID cards.

- Supports Mifare 1K RFID cards
- Card gap has backlight
- Configuration, programming and debugging is done using PC based tool through USB port
- Resource sharing between controllers through BACnet network.
- Sharing of the data is performed without intervention of the supervisory system
- Jumper selectable standard polarizing and termination resistors on RS485 terminal

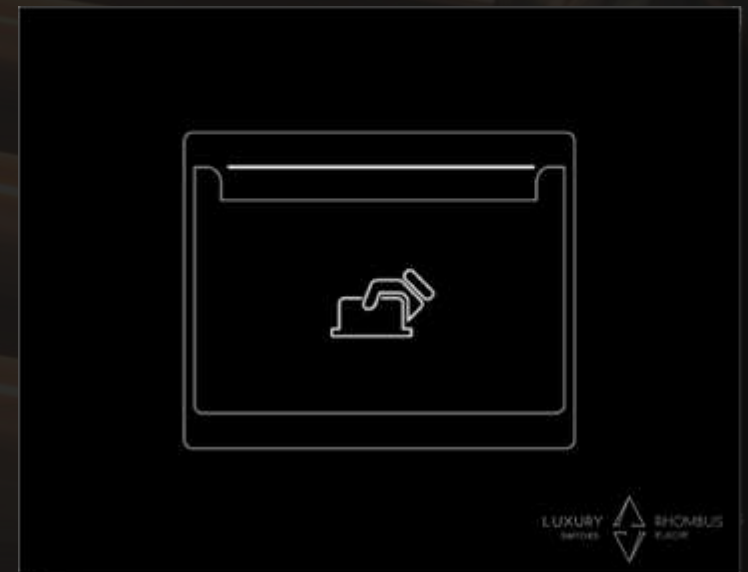

THERMOSTAT

Programmable home thermostat can be used for control of various air conditioning and heating systems such as fan coils, split systems etc.

Device features QVGA (320x240) TFT color display, 10 capacitive keys with two color dimmable backlight and embedded temperature probe.

The device communicates with the rest of the system using RS485 port.

The device can provide additional functionality thanks to a collection of analog and digital inputs and outputs.



THERMOSTAT

Features:

- Color display
- 10 capacitive keys with bicolor backlight
- Embedded temperature probe
- High level of flexibility thanks to a wide range of IO resources
- Configuration, programming and debugging is done using PC based tool through USB port
- Resource sharing between controllers through BACnet network.
- Sharing of the data is performed without intervention of the supervisory system
- Jumper selectable standard polarizing and termination resistors on
- RS485 terminal



ECO COMFORT



WALL TOUCH PANEL

Wall touch panel is a programmable keypad unit for use in hotel rooms or home. It can be used as user interface in various automation systems.

Device features 9 or 12 capacitive keys with two color dimmable backlight.

The device communicates with the rest of the system using RS485 port.

- 9 or 12 capacitive keys with bicolor backlight
- Configuration, programming and debugging is done using PC based tool through USB port
- Resource sharing between controllers through BACnet network.
- Sharing of the data is performed without intervention of the supervisory system
- Jumper selectable standard polarizing and termination resistors on RS485 terminal



EXAMPLE OF WALL TOUCH PANELS



EXAMPLE OF WALL TOUCH PANELS



EXAMPLE OF WALL TOUCH PANELS





THANK YOU!

www.rhombus-europe.com

Factory - Varna (Bulgaria) – 450 m2

Address: 6 Yann Hunyadi Blvd. /

Varna 9000 / BULGARIA

Tel: +359 899 145 110

Offices - Varna (Bulgaria) – 200 m2

Address: 6 Yann Hunyadi Blvd. /

Varna 9000 / BULGARIA

Tel: +359 889 157 817